

- ▶ Internal drawer 100, height 70 mm
- ▶ Powder coated steel, anthracite

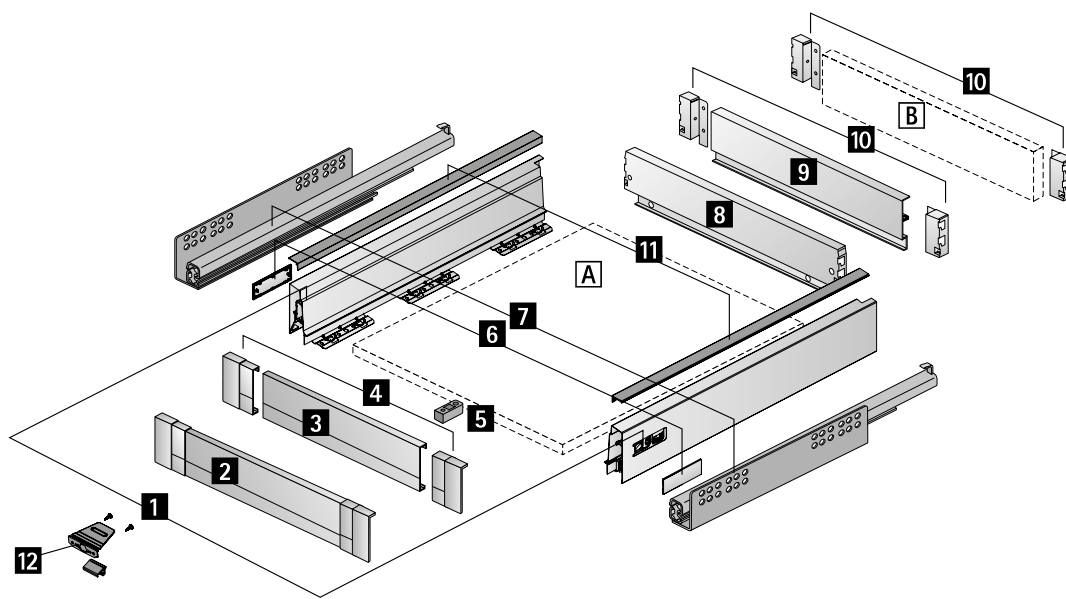

Exploded diagram



## Components

- 1** Drawer side profile, left and right
- 2** Front panel
- Alternatively:**
  - 3** Aluminium front panel and
  - 4** Connector for aluminium front panel
- 5** Front stabiliser
- 6** Cover cap, 2 each
- 7** Quadro drawer runner, left and right, see page 950 - 951
- 8** Steel rear panel
- Alternatively:**
  - 9** Aluminium rear panel or **B** Wooden rear panel and
  - 10** Rear panel connector, left and right
- A** Bottom panel (material thickness 16 mm)
- B** Wooden rear panel (material thickness 16 mm)

## Advice

- ▶ For technical information, see pages 996, 1009 - 1023
- ▶ For Quadro drawer runner, see page 950 - 951

- ▶ Internal drawer 100, height 70 mm
- ▶ Powder coated steel, anthracite

## Components

### 1 Drawer side profile



Nominal length mm	Order no.		PU
	left	right	
260	9 194 418	9 194 419	18 ea.
300	9 194 420	9 194 421	18 ea.
350	9 194 422	9 194 423	18 ea.
420	9 194 424	9 194 425	18 ea.
470	9 194 426	9 194 427	18 ea.
520	9 194 428	9 194 429	18 ea.
620	9 194 430	9 194 431	18 ea.

### 6 Cover cap

- ▶ Plastic
- ▶ Cover cap with customised imprint available on request



Finish	Order no.	PU
Dark grey with Hettich logo	9 194 648	1/300 ea.
Dark grey	9 194 645	1/300 ea.
Stainless steel look with Hettich logo	9 194 656	1/300 ea.
Stainless steel look	9 194 655	1/300 ea.

### 8 Steel rear panel

- ▶ For standard carcass width



Carcass width mm	Order no.	PU
275	9 194 451	1/40 ea.
300	9 194 452	1/40 ea.
350	9 194 453	1/40 ea.
400	9 194 454	1/40 ea.
450	9 194 455	1/40 ea.
500	9 194 456	1/40 ea.
550	9 194 457	1/40 ea.
600	9 194 458	1/40 ea.
700	9 194 459	1/20 ea.
800	9 194 460	1/20 ea.
900	9 194 461	1/20 ea.
1000	9 194 462	1/20 ea.
1200	9 194 463	1/20 ea.

### 10 Rear panel connector

- ▶ For wooden or **9** Aluminium rear panel



Nominal height mm	Order no.		PU
	left	right	
70	9 194 629	9 194 630	40 ea.

### 9 Aluminium rear panel

- ▶ For variable or standard carcass width
- ▶ For cutting to length
- ▶ Length 2000 mm
- ▶ Powder coated, anthracite
- ▶ **10** Rear panel connectors must be ordered separately



Order no.	PU
9 194 519	1 ea.

- ▶ Internal drawer 100, height 70 mm
- ▶ Powder coated steel, anthracite

## Front panel for internal drawer

### 2 Front panel

- ▶ For standard carcass width
- ▶ With premounted connectors
- ▶ Powder coated aluminium, anthracite / plastic, dark grey



Carcass width mm	Order no.	PU
300	9 194 737	1/20 ea.
400	9 194 738	1/20 ea.
450	9 194 739	1/20 ea.
500	9 194 740	1/20 ea.
600	9 194 741	1/20 ea.
800	9 194 742	1/20 ea.
900	9 194 743	1/20 ea.
1000	9 194 744	1/20 ea.
1200	9 194 745	1/20 ea.

### 3 Aluminium front panel

- ▶ For variable or standard carcass width
- ▶ For cutting to length
- ▶ Length 2000 mm
- ▶ Powder coated, anthracite
- ▶ **4** Connectors for aluminium front panel must be ordered separately



Order no.	PU
9 194 766	1 ea.

### 4 Connector for aluminium front panel

- ▶ For combination with **3** Aluminium front panel
- ▶ Plastic, dark grey



Order no.	PU
9 196 349	1 pair

### 5 Front stabiliser

- ▶ For stabilising wide front panels
- ▶ Recommended for use with carcasses in a width of 600 mm and over
- ▶ Plastic, white



Order no.	PU
9 117 782	1/100 ea.