

- ▶ Internal drawer 100, height 70 mm
- ▶ Powder coated steel, white

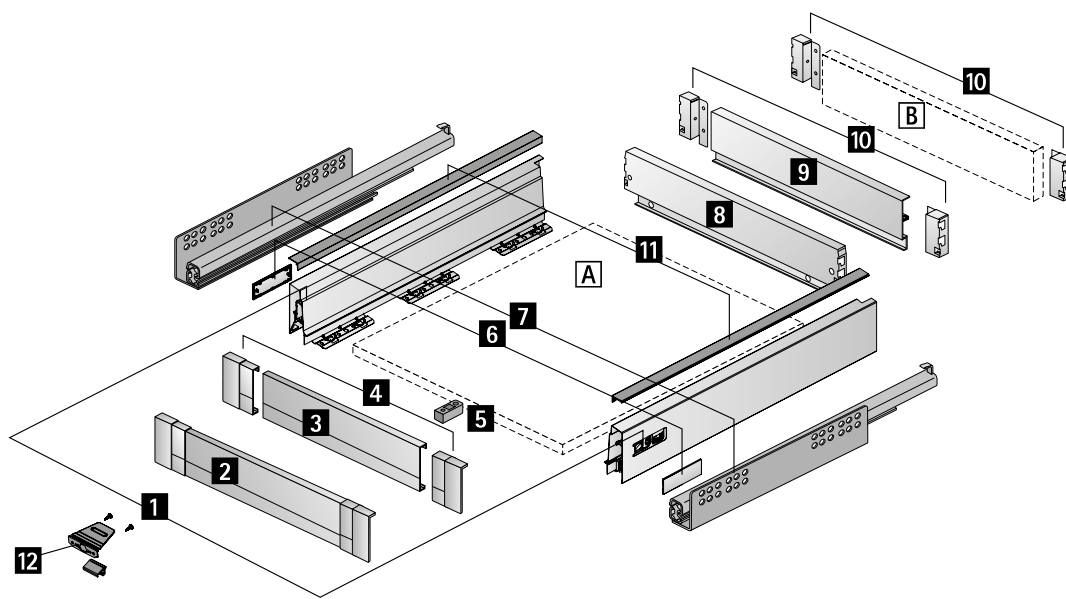

Exploded diagram



Components

- 1** Drawer side profile, left and right
- 2** Front panel
- Alternatively:**
 - 3** Aluminium front panel and
 - 4** Connector for aluminium front panel
- 5** Front stabiliser
- 6** Cover cap, 2 each
- 7** Quadro drawer runner, left and right, see page 950 - 951
- 8** Steel rear panel
- Alternatively:**
 - 9** Aluminium rear panel or **B** Wooden rear panel and
 - 10** Rear panel connector, left and right
- A** Bottom panel (material thickness 16 mm)
- B** Wooden rear panel (material thickness 16 mm)

Advice

- ▶ For technical information, see pages 996, 1009 - 1023
- ▶ For Quadro drawer runner, see page 950 - 951

- ▶ Internal drawer 100, height 70 mm
- ▶ Powder coated steel, white

Components

1 Drawer side profile



Nominal length mm	Order no.		PU
	left	right	
260	9 194 404	9 194 405	18 ea.
300	9 194 406	9 194 407	18 ea.
350	9 194 408	9 194 409	18 ea.
420	9 194 410	9 194 411	18 ea.
470	9 194 412	9 194 413	18 ea.
520	9 194 414	9 194 415	18 ea.
620	9 194 416	9 194 417	18 ea.

6 Cover cap

- ▶ Plastic
- ▶ Cover cap with customised imprint available on request



Finish	Order no.	PU
White with Hettich logo	9 194 647	1/300 ea.
White	9 194 644	1/300 ea.
Chrome look with Hettich logo	9 194 653	1/300 ea.
Chrome look	9 194 650	1/300 ea.

8 Steel rear panel

- ▶ For standard carcass width



Carcass width mm	Order no.	PU
275	9 194 438	1/40 ea.
300	9 194 439	1/40 ea.
350	9 194 440	1/40 ea.
400	9 194 441	1/40 ea.
450	9 194 442	1/40 ea.
500	9 194 443	1/40 ea.
550	9 194 444	1/40 ea.
600	9 194 445	1/40 ea.
700	9 194 446	1/20 ea.
800	9 194 447	1/20 ea.
900	9 194 448	1/20 ea.
1000	9 194 449	1/20 ea.
1200	9 194 450	1/20 ea.

10 Rear panel connector

- ▶ For wooden or **9** aluminium rear panel



Nominal height mm	Order no.		PU
	left	right	
70	9 194 627	9 194 628	40 ea.

9 Aluminium rear panel

- ▶ For variable or standard carcass width
- ▶ For cutting to length
- ▶ Length 2000 mm
- ▶ Powder coated, white
- ▶ **10** Rear panel connectors must be ordered separately



Order no.	PU
9 194 518	1 ea.

- ▶ Internal drawer 100, height 70 mm
- ▶ Powder coated steel, white

Front panel for internal drawer

2 Front panel

- ▶ For standard carcass width
- ▶ With premounted connectors
- ▶ Powder coated aluminium, white / plastic, white



Carcass width mm	Order no.	PU
300	9 194 728	1/20 ea.
400	9 194 729	1/20 ea.
450	9 194 730	1/20 ea.
500	9 194 731	1/20 ea.
600	9 194 732	1/20 ea.
800	9 194 733	1/20 ea.
900	9 194 734	1/20 ea.
1000	9 194 735	1/20 ea.
1200	9 194 736	1/20 ea.

3 Aluminium front panel

- ▶ For variable or standard carcass width
- ▶ For cutting to length
- ▶ Length 2000 mm
- ▶ Powder coated, white
- ▶ **4** Connectors for aluminium front panel must be ordered separately



Order no.	PU
9 194 765	1 ea.

4 Connector for aluminium front panel

- ▶ For combination with **3** Aluminium front panel
- ▶ Plastic, white



Order no.	PU
9 196 348	1 pair

5 Front stabiliser

- ▶ For stabilising wide front panels
- ▶ Recommended for use with carcasses in a width of 600 mm and over
- ▶ Plastic, white



Order no.	PU
9 117 782	1/100 ea.