

- ▶ Internal drawer 100, height 70 mm
- ▶ Powder coated steel, silver

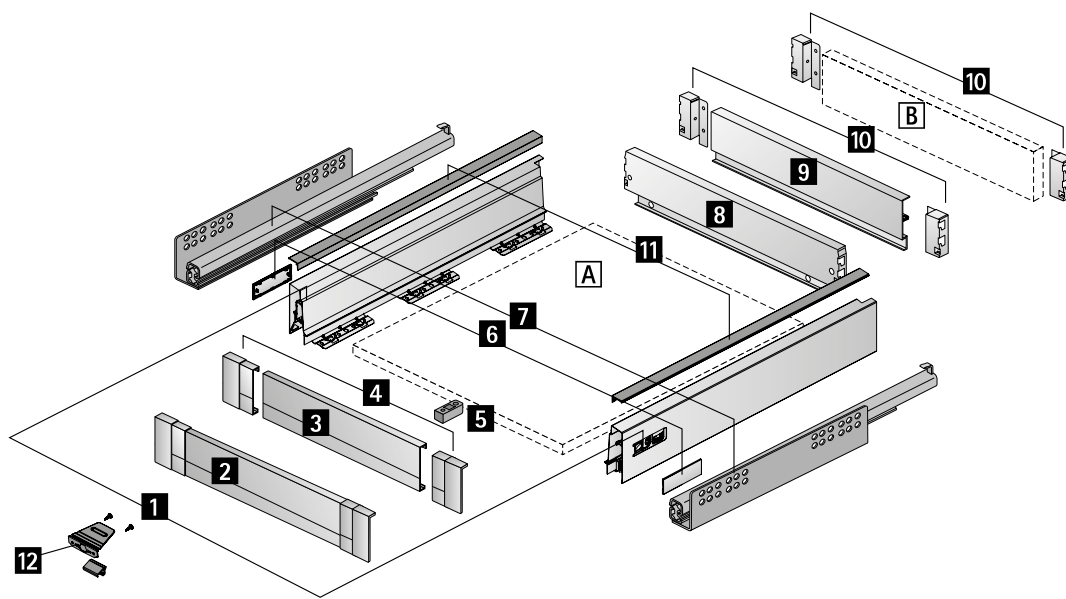

### Exploded diagram



### Components

- 1** Drawer side profile, left and right
- 2** Front panel
- Alternatively:**
  - 3** Aluminium front panel and
  - 4** Connector for aluminium front panel
- 5** Front stabiliser
- 6** Cover cap, 2 each
- 7** Quadro drawer runner, left and right, see page 950 - 951
- 8** Steel rear panel
- Alternatively:**
  - 9** Aluminium rear panel or **B** Wooden rear panel and
  - 10** Rear panel connector, left and right
- A** Bottom panel (material thickness 16 mm)
- B** Wooden rear panel (material thickness 16 mm)

### Advice

- ▶ For technical information, see pages 996, 1009 - 1023
- ▶ For Quadro drawer runner, see page 950 - 951

- ▶ Internal drawer 100, height 70 mm
- ▶ Powder coated steel, silver

## Components

### 1 Drawer side profile



Nominal length mm	Order no.		PU
	left	right	
260	9 194 390	9 194 391	18 ea.
300	9 194 392	9 194 393	18 ea.
350	9 194 394	9 194 395	18 ea.
420	9 194 396	9 194 397	18 ea.
470	9 194 398	9 194 399	18 ea.
520	9 194 400	9 194 401	18 ea.
620	9 194 402	9 194 403	18 ea.

### 6 Cover cap

- ▶ Plastic
- ▶ Cover cap with customised imprint available on request



Finish	Order no.	PU
Grey with Hettich logo	9 194 646	1/300 ea.
Grey	9 194 643	1/300 ea.
Chrome look with Hettich logo	9 194 652	1/300 ea.
Chrome look	9 194 649	1/300 ea.

### 8 Steel rear panel

- ▶ For standard carcass width



Carcass width mm	Order no.	PU
275	1 061 900	1/40 ea.
300	1 061 901	1/40 ea.
350	1 061 902	1/40 ea.
400	1 061 903	1/40 ea.
450	1 061 904	1/40 ea.
500	1 061 905	1/40 ea.
550	1 061 906	1/40 ea.
600	1 061 907	1/40 ea.
700	1 063 664	1/20 ea.
800	1 062 960	1/20 ea.
900	1 062 961	1/20 ea.
1000	1 063 667	1/20 ea.
1200	9 004 102	1/20 ea.

### 10 Rear panel connector

- ▶ For wooden or 9 Aluminium rear panel



Nominal height mm	Order no.		PU
	left	right	
70	1 062 501	1 062 502	40 ea.

### 9 Aluminium rear panel

- ▶ For variable or standard carcass width
- ▶ For cutting to length
- ▶ Length 2000 mm
- ▶ Powder coated, silver
- ▶ 10 Rear panel connectors must be ordered separately



Order no.	PU
0 077 913	1 ea.

- ▶ Internal drawer 100, height 70 mm
- ▶ Powder coated steel, silver

## Front panel for internal drawer

### 2 Front panel

- ▶ For standard carcass width
- ▶ With premounted connectors
- ▶ Powder coated aluminium, silver / grey plastic



Carcass width mm	Order no.	PU
300	9 194 719	1/20 ea.
400	9 194 720	1/20 ea.
450	9 194 721	1/20 ea.
500	9 194 722	1/20 ea.
600	9 194 723	1/20 ea.
800	9 194 724	1/20 ea.
900	9 194 725	1/20 ea.
1000	9 194 726	1/20 ea.
1200	9 194 727	1/20 ea.

### 3 Aluminium front panel

- ▶ For variable or standard carcass width
- ▶ For cutting to length
- ▶ Length 2000 mm
- ▶ Powder coated, silver
- ▶ **4** Connectors for aluminium front panel must be ordered separately



Order no.	PU
9 194 764	1 ea.

### 4 Connector for aluminium front panel

- ▶ For combination with **3** Aluminium front panel
- ▶ Plastic, grey



Nominal height mm	Order no.	PU
70	9 104 107	1 pair

### 5 Front stabiliser

- ▶ For stabilising wide front panels
- ▶ Recommended for use with carcasses in a width of 600 mm and over
- ▶ Plastic, white



Order no.	PU
9 117 782	1/100 ea.